

Explore the property...

EPC & Floor Plans



99 Reeds Avenue East, Leasowe
CH46 1RG

£155,000

bradshaw
farnham
& lea

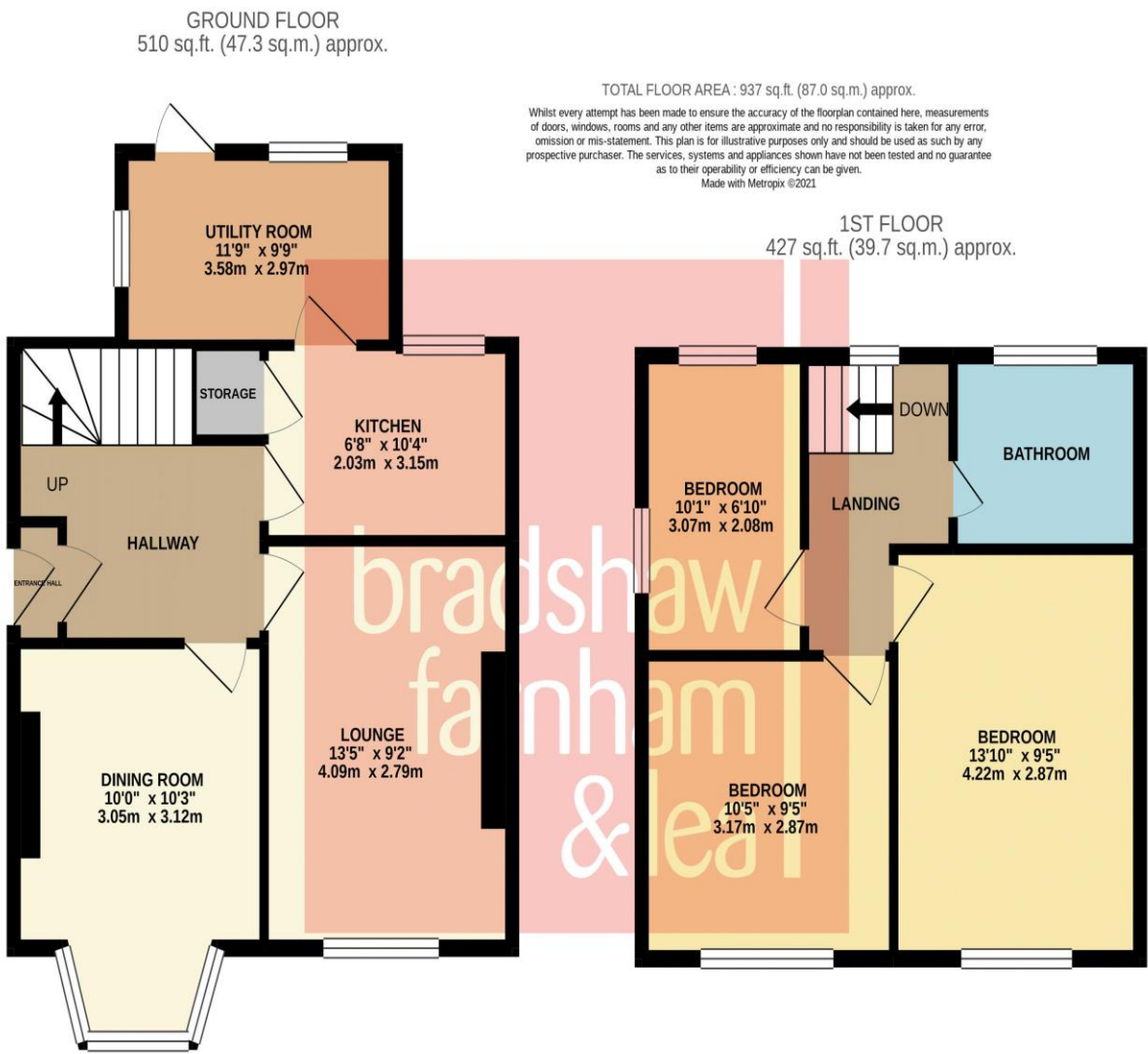

Tenure: Freehold



The Small Print...

Agents Note: These particulars are thought to be correct, though their accuracy cannot be guaranteed and they do not form part of any contract. Please note that we have not tested any apparatus, fixtures, fittings or services and as such cannot verify that they are in working order or fit for their purpose. Furthermore, solicitors should confirm that moveable items described in the sales particulars are, in fact, included in the sale since circumstances do change during marketing or negotiations. A final inspection prior to exchange of contracts is also recommended. Although we try to ensure accuracy, measurements used in this brochure may be approximate. Therefore, if intending purchasers need accurate measurements to order carpeting, or to ensure existing furniture will fit, they should take such measurements themselves.

Contact Bradshaw Farnham & Lea - Moreton
Call - 0151 678 9760
Email - moreton@bflhomes.co.uk
Visit - 256 Hoylake Road Moreton

rightmove



- Three Bedrooms
- Semi Detached
- No Chain

- Two Reception Rooms
- Utility Room
- Viewing Recommended

www.bflhomes.com

About the property...

Offered for sale with no ongoing chain and situated in a prime location close to Leasowe Train Station this property is on a corner plot boasting gardens to the front, side and rear. Internally the property comprises: Entrance porch, entrance hall, dining room, lounge, fitted kitchen, utility room, landing, three bedrooms and a family bathroom. To the exterior there are front, side and rear gardens with secure gated parking to the rear. Early viewing is highly recommended to fully appreciate what is on offer.

About the location...

From the agents Moreton office proceed along Hoylake Road towards Moreton Cross. At the roundabout go straight ahead. When you reach Aldi turn left onto Reeds Lane and go straight ahead over Leasowe Train Station. Turn right into Birket Avenue and then turn left into Reeds Avenue East. The property is located on the corner of Birket Avenue and Reeds Avenue East.

